

Fiber Optic Splice Closure

GJS03-M8AX Series

GJS03-M8AX-JX-144D-Mechanical Sealing Way

Specification

GJS03-M8AX Catalogue



General Introduction

GJS03-M8AX-JX-144D dome Fiber Optic Splice Closure (FOSC) are mechanical sealing closures for ease of installation and re-entry, and cable seals feature a unique rubber buffer system that is available for many kinds of fiber cable, especially for FTTx solutions. Common materials, accessories, and practices are used throughout the product line to simplify training, reduce inventory, and enhance productivity. All sizes are designed for use with any cable construction (loose buffer tube, central core tube, loose fiber, and ribbon), in any environment (aerial, pole mounting, wall mounting, pedestal, buried, hand hole and manhole), and for numerous splice applications (express, tap-off, branch, and repair) offering full tightness (IP 68) in all scenarios. The vulcanized sealing rubber plug can be customized for what kinds of fiber cable will be used, allowing mid span access.

Main parameter:

Materials	Dome and base: PP alloy (Optional) tray: ABS
Max capacity	144 fibers (6 trays) + Spare Fibers Tray
Max capacity of tray	24 fibers (single fibers)
Sealing method	Mechanical
Using Environment	Aerial, pole mounting, wall mounting, pedestal, buried, hand hole and manhole
Outlet and inlet	5 ports (1 oval port for un-cut cable available for 2 cables go in, other 4 round ports for regular cable)
Suitable Cable	Please select different sizes of rubbers according to <i>“Optional Rubber Plug</i>

Diameter (mm)	<i>Diameter"</i>
IP Degree	IP 68
Dimensions (mm)	Height: 550mm Base diameter: 216*243mm
Weight (kg)	4.3~4.8

Technical Parameter:

1. Working Temperature: -40 °C ~ +60 °C
2. Atmospheric Pressure: 70 K Pa ~ 150 K Pa
3. Axial Tension: > 2000N / 1min
4. Stretching Resistance: 2940N / 10 square centimeter (1min)
5. Insulation resistance: > 2*10⁴MΩ
6. Voltage Strength: 15KV/1min, no arc over or breakdown
7. Pressure in the water: 50m / 72hours
8. Splice tray with optical taking-in radius ≥ 40mm for low optical loss.

Closure description:

1. Dome: It is made by PP alloy with special elements which provide excellent performance in different using circumstance such as anti-UV, anti- corrosive, antifreeze and fungi resistant.



2. Base: The base provides the function of holding the splicing trays and it is designed with 5 ports (1 oval port for un-cut cable available for 2 cables go in, other 4 round ports for regular cable. All the ports are available for different kinds of rubber buffer according to the cable diameter. It is also made by PP alloy with special elements which provide excellent performance in different using circumstance such as anti-UV, anti- corrosive, antifreeze and fungi resistant.

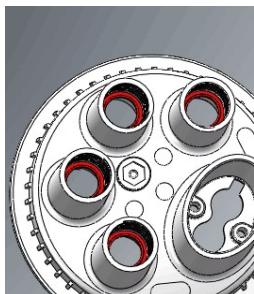

2.1 Optional Rubber Plug Diameter

Oval port: Rubber Optional



Round ports: Rubber Optional

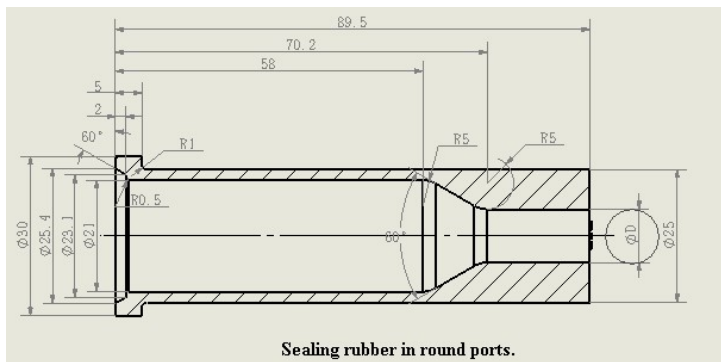

Seal Type	Available Cable Diameter
M8TMFQ-D5 (round port)	5 ~ 8 mm
M8TMFQ-D9 (round port)	9 ~ 12 mm
M8TMFQ-D13 (round port)	13 ~ 16 mm
M8TMFQ-D17 (round port)	17 ~ 20 mm
Drop cable sealing rubber (round port)	8 drop cable
M1TM-D (oval port)	8 ~ 22 mm (2 cables)

Customized plug depending on fiber cable diameter and number of cables can be included

3. Closing ring: Consists of one reusable rubber ring and closing hook. The hook is made by PP alloy with nylon.

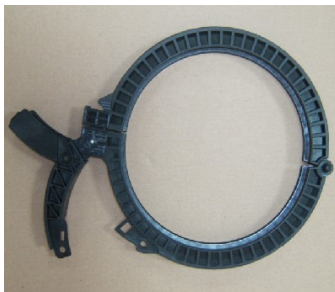

4. Tray Tower: The mounting bracket is available for 6 trays and one tray for fiber spare in the same direction.



5. Fiber cable strength member system: The central member of each individual cable can be attached at this point. Whatever main cable or branch cables, including FTTx cable are available. Moreover, the jacket of each cable can be fixed to the closure.

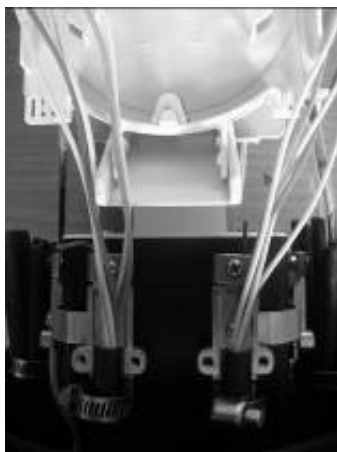

6. Grounding device: A sealed grounding device can be pre-mounted in the base to connect metallic components to an external ground.



7. Flash test valve: It is optional kits, made of non-corrosive copper.



8. Spare Fiber Tray: Used for coiling of uncut cable

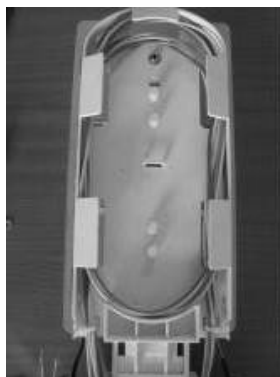

Accessories:

The accessories included in the FOSC: grounding wire, nylon tie, emery paper, buffer tube, metal hoop, sealing tape, insulation tape, special wrench, grounding device, pressure testing valve, splice fusion tube, rubber seals (optional according what kind of fiber cable will be used), seals for all cable ports / access, kit subjection to air, pole and wall.